

Assembly step **13** Attaching swing arm

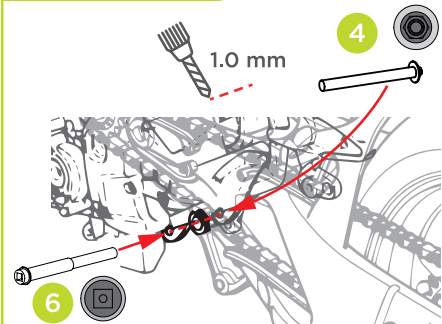

Replace 1.2x8 mm screw with parts **4** and **6**

Assembly step **15**



Replace 1.2x4 mm screw with part **7**

Assembly step **23**



Replace 1.2x2.5 mm screws with part **8**

Assembly step **25**

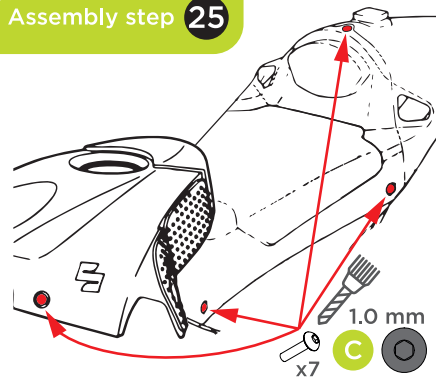

Replace seat and fuel tank studs with part **C**

Assembly step **26**

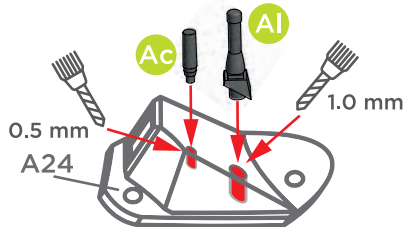

Assembly step **28**

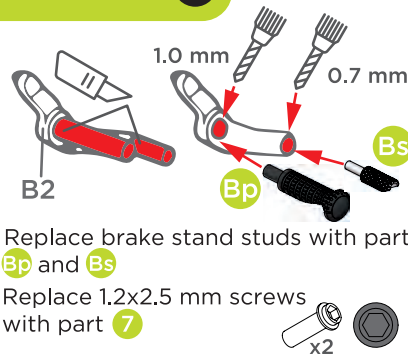

Replace brake stand studs with parts **Bp** and **Bs**

Replace 1.2x2.5 mm screws with part **7**

Assembly step **31**

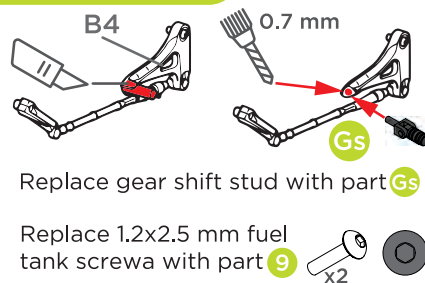

Replace gear shift stud with part **Gs**

Replace 1.2x2.5 mm fuel tank screws with part **9**

Assembly step **32-33**

Replace **simulated screws** around **windscreen** with part **W**

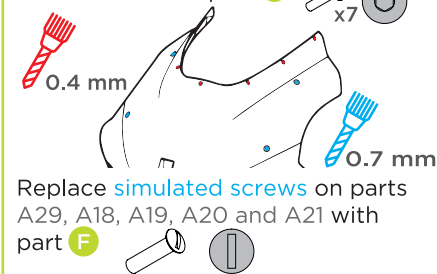





Replace **simulated screws** on parts A29, A18, A19, A20 and A21 with part **F**

Assembly step **34-35**

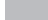
Replace 1.2x4 mm screws with part **10**

Paints guide

-  Polished aluminium
-  Metal copper
-  Black
-  Gun Metal

**decalcas**

DCL-PAR072

1/12 detail-up set

Rear brake and detail-up parts for Suzuki Ecstar GSX-RR'20 by Tamiya

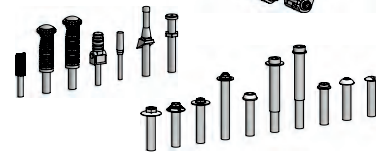
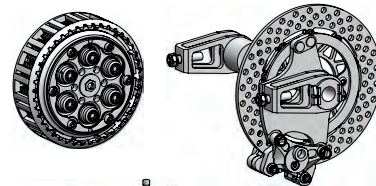

PARTS

Assembly step **1** Modify original part D49

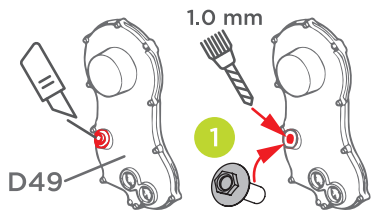

Assembly step **2**

Replace original part D56

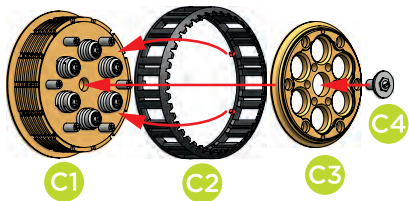

Note: 3D resin is brittle, cut the supports carefully with sharp pliers first by the base and then by the back of the part. Then sand the remaining supports to a smooth surface.

Assembly step **5** Replace gear shift stand

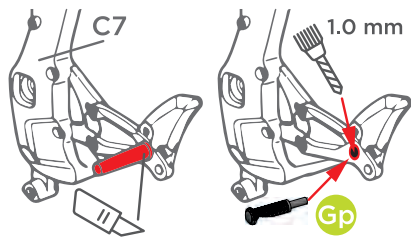

Assembly step **6**

Replace 3 of 4 metal screws placing in these holes with parts **2**, **3** and **4**

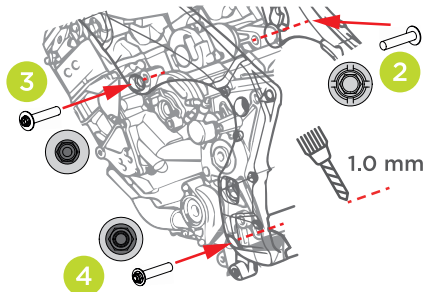

Assembly step **8** Modify swing arm

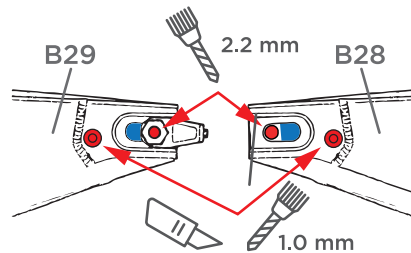

Drill spindle center hole 2.2 mm  
Remove stand pin and drill 1.0 mm  
Hollow out blue marked zones

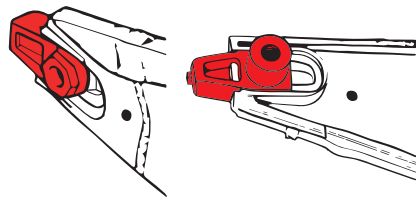

Remove chain tensioner on part B29 (marqued in red).  
The final appearance of this area must be like that of piece B28.

Assembly step **8** Modify swing arm

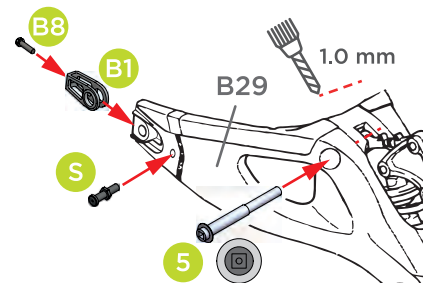

Fix shock absorber replacing 1.2x8 mm screw with part **5**

Assembly step **9** Attaching chain

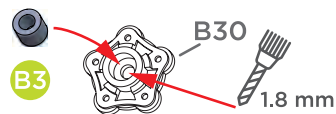

Drill 1.8 mm on rear sprocket flange and insert part **B3**

Assembly step **11** Attaching rear wheel

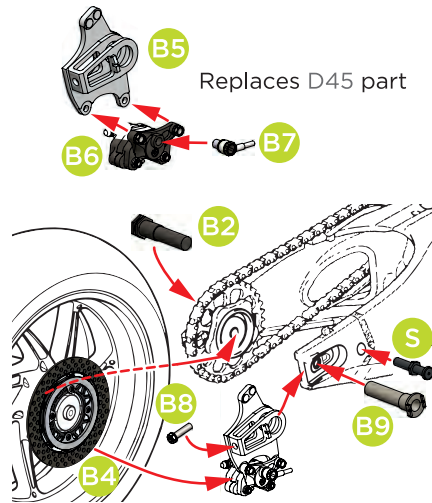

Place chain tensioner + caliper on swing arm replacing D45 part.  
Place disk brake on the rim and insert the wheel on place, then insert spindles **B2** and **B9**  
Replace right stand with part **S**